



Inductive sensor

NJ1,5-18GM-N-D-V1-Y29033

- 1.5 mm flush
- Compression proof up to 350 bar, dynamic on active surface



Dimensions

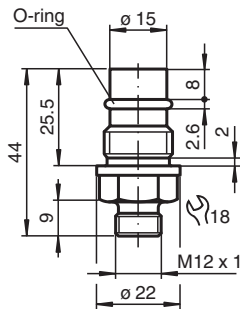

Technical Data

| General specifications | | |
|------------------------------|-------|----------------------|
| Switching function | | Normally closed (NC) |
| Output type | | NAMUR |
| Rated operating distance | s_n | 1.5 mm |
| Installation | | flush |
| Assured operating distance | s_a | 0 ... 1.22 mm |
| Reduction factor r_{AI} | | 0 |
| Reduction factor r_{Cu} | | 0 |
| Reduction factor r_{304} | | 0.55 |
| Output type | | 2-wire |
| Nominal ratings | | |
| Nominal voltage | U_o | 8 V |
| Switching frequency | f | 0 ... 400 Hz |
| Hysteresis | H | typ. % |
| Current consumption | | |
| Measuring plate not detected | | min. 3 mA |
| Measuring plate detected | | ≤ 1 mA |

Release date: 2023-01-26 Date of issue: 2023-01-26 Filename: 70139683_eng.pdf

Refer to "General Notes Relating to Pepperl+Fuchs Product Information".

Pepperl+Fuchs Group
www.pepperl-fuchs.com

USA: +1 330 486 0001
fa-info@us.pepperl-fuchs.com

Germany: +49 621 776 1111
fa-info@de.pepperl-fuchs.com

Singapore: +65 6779 9091
fa-info@sg.pepperl-fuchs.com

PEPPERL+FUCHS

Technical Data

| | |
|---|---|
| Limit data | |
| Operating pressure | 350 bar (5076.4 psi) |
| Compliance with standards and directives | |
| Standard conformity | |
| NAMUR | EN 60947-5-6:2000 IEC 60947-5-6:1999 |
| Standards | EN 60947-5-2:2007 EN 60947-5-2/A1:2012 IEC 60947-5-2:2007 IEC 60947-5-2 AMD 1:2012 |
| Approvals and certificates | |
| IECEX approval | |
| Equipment protection level Gb | IECEX PTB 11.0037X |
| Equipment protection level Da | IECEX PTB 11.0037X |
| Equipment protection level Mb | IECEX PTB 11.0037X |
| ATEX approval | |
| Equipment protection level Gb | PTB 00 ATEX 2048 X |
| Equipment protection level Da | PTB 00 ATEX 2048 X |
| UL approval | |
| | cULus Listed, Class 2 Power Source |
| Ambient conditions | |
| Ambient temperature | -25 ... 85 °C (-13 ... 185 °F) |
| Mechanical specifications | |
| Connection type | 4-pin, M12 x 1 connector |
| Housing material | Stainless steel 1.4305 / AISI 303 |
| Sensing face | Ceramic |
| Degree of protection | IP67 |
| General information | |
| Use in the hazardous area | see instruction manuals |

Connection

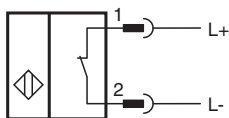

Connection Assignment

